

PARTICULARS OF MACHINARIES EQUIPMENTS & HP				
SLNO	DESCRIPTION	QTY	UNIT	TOTAL
1	FORGING PRESS	1	5.00	5.00
2	LPG FURNACE	1	-	-
3	TRIMMING PRESS	1	1.00	1.00
4	DE OIL M/C	1	1.00	1.00
5	CUTTING M/C	1	3.00	3.00
6	1st OPERATION AUTOLATHE	1	7.50	7.50
7	1st OPERATION	1	7.50	7.50
8	2nd OPERATION	1	4.00	4.00
9	2nd OPERATION	1	4.00	4.00
10	2nd OPERATION	1	4.00	4.00
11	THREADING M/C	1	5.00	5.00
12	THREADING M/C	1	5.00	5.00
13	CENTRE LATHE	1	3.00	3.00
14	TOOL & CUTTER GRINDER	1	1.00	1.00
15	BENCH GRINDER	1	0.33	0.33
16	CLEANING M/C	1	2000 W	2.68
17	TESTING M/C (AIR LEAK)	1	-	-
18	TESTING M/C	1	-	-
19	TESTING M/C	1	-	-
20	GENERATOR (40 KVA)	1	-	-
21	AIR COMPRESSOR	1	3.00	3.00
22	AIR COMPRESSOR	1	5.00	5.00
23	MES. PANEL BOARD	1	-	-
24	IZOD TESTING M/C	1	-	-
25	TENSIL TESTIN M/C	1	5.00	5.00
26	OVEN	1	750 W	1.00
27	20°C CHEAMBER	1	0.33	0.33
28	PROFILE PROJECTOR	1	200 W	0.27
29	INSPECTION TABLE	1	-	-
TOTAL HP				68.61

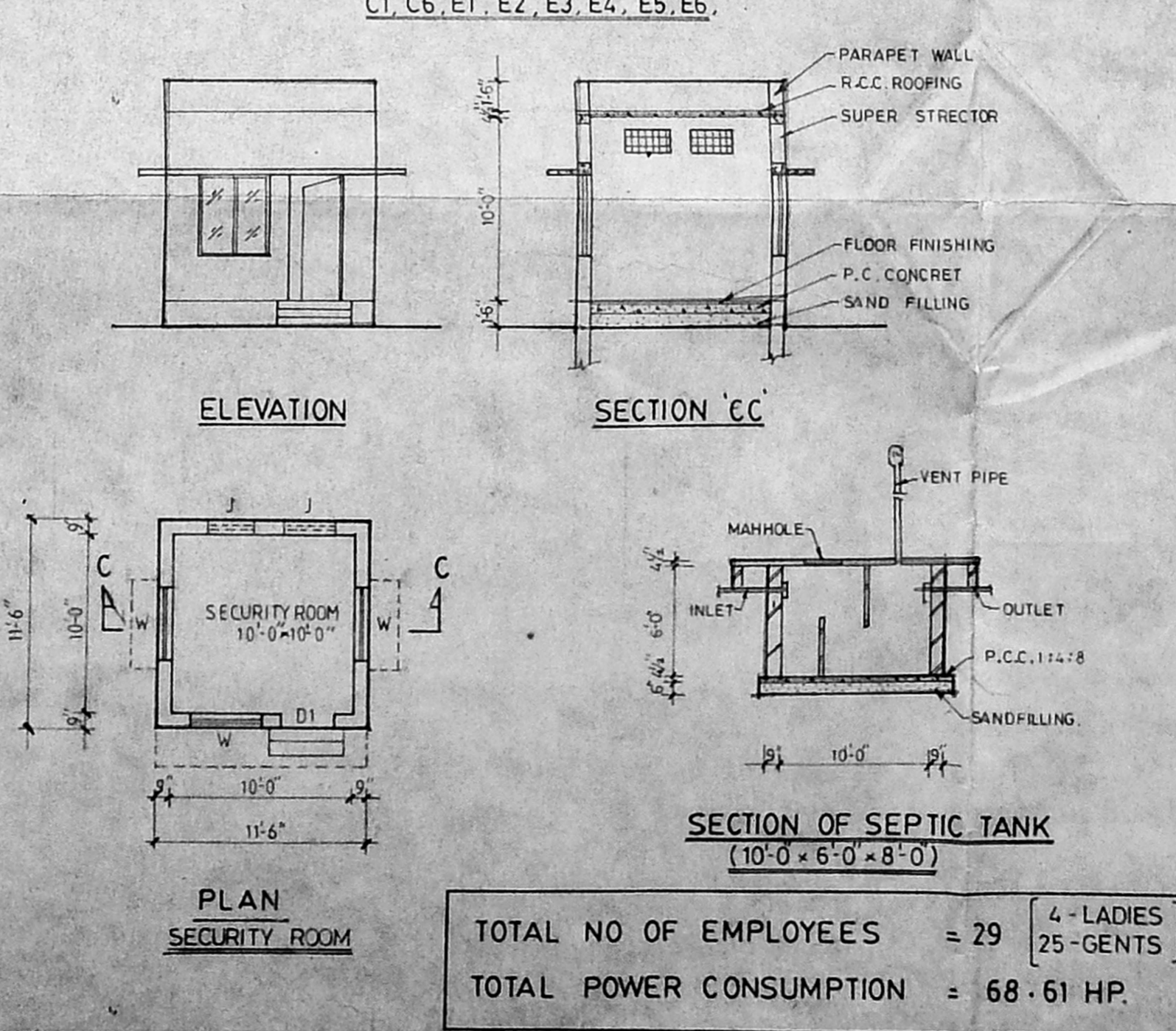
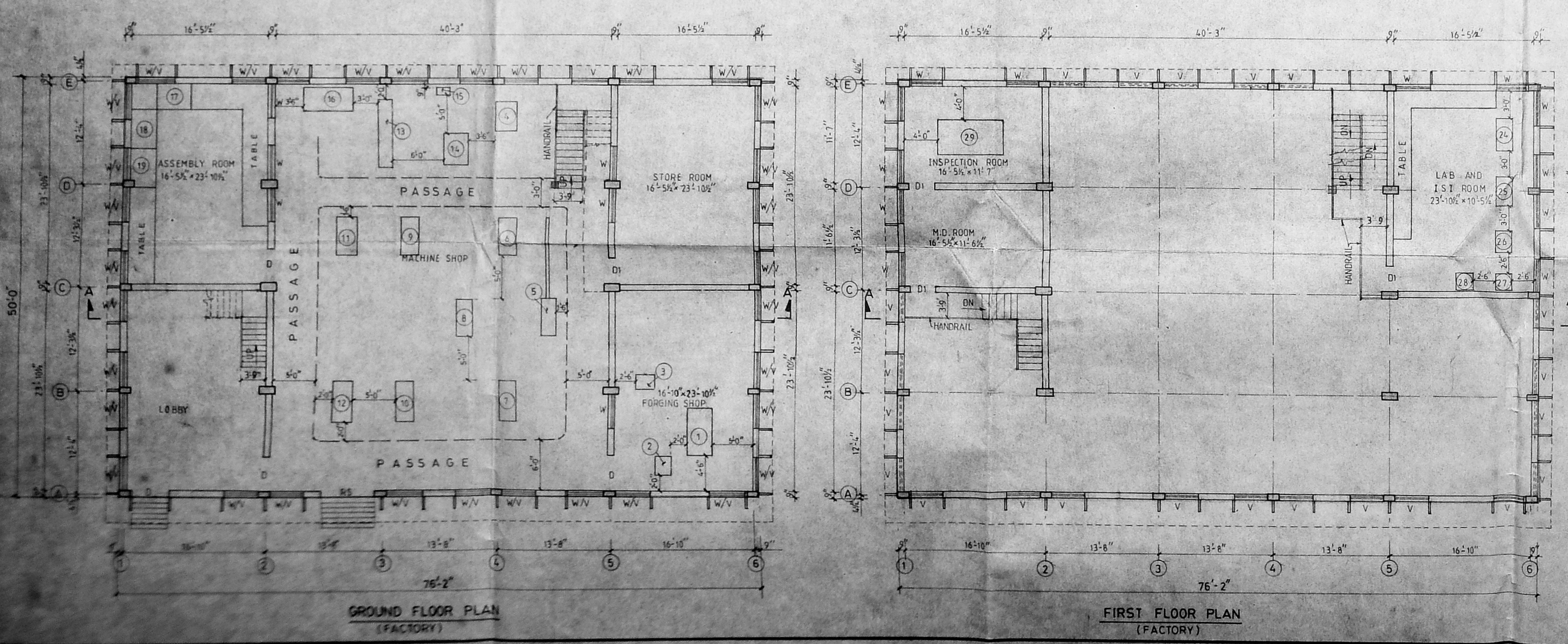

JOINERY DETAILS		
TYPE	DESCRIPTION	SIZE
RS	ROLLING SHUTTER	6'-0" x 8'-0"
D	DOOR	4'-0" x 7'-0"
D1	DOOR	3'-0" x 7'-0"
D2	DOOR	2'-6" x 6'-6"
W0	WINDOW	4'-0" x 4'-6"
W	WINDOW	4'-0" x 4'-6"
V	VENTILATOR	4'-0" x 1'-6"
V1	VENTILATOR	4'-0" x 2'-0"
V2	VENTILATOR	2'-0" x 1'-3"
RS1	ROLLING SHUTTER	5'-0" x 8'-0"

AREA DETAILS SQ.-FT. - SQ.M		COLOUR INDEX
PLOT AREA	1704.0 - 158.92	PROPOSED
GROUND FLOOR FACTORY	3808.3 - 354.23	ROAD
FIRST FLOOR FACTORY	1297.9 - 120.74	BOUNDARY
SERVICES BLOCK	780.0 - 72.56	
SECURITY ROOM	132.3 - 12.30	
TOILET	90.0 - 8.37	

DRAWN: P.S. JOTHI, N.A.C. Draughtman (Civil)

CHECKED: SUREKHA CONSULTING ENGINEERS PROJECT ENGINEER

PREPARED BY: SUREKHA CONSULTING ENGINEERS  
33, MOUNT ROAD, LITTLE MOUNT, SAIDAPET, MADRAS - 600 015. TINKLE: 2350884

CLIENT: SPEC CYLINDER ACCESSORIES P.LTD. MADRAS-98.

OWNER: SPEC CYLINDER ACCESSORIES (P) LTD. Managing Director

SCALE: 1'-8" (1:100)

PL-94-043.

**PLAN SHOWING THE PROPOSED CONSTRUCTION BUILDING FOR M/S. SPEC CYLINDER ACCESSORIES P. LTD. IN KAMALA NAGAR, SHOLINGANALLUR VILLAGE, NO:189, S.NO:476/4, CHENGLE PUT DIST, SAIDAPET TALUK, MADRAS-600 096.**